



Snap-In Bushings

For knockouts. All-plastic, snap-in type.



CATALOG NUMBER	UPC/DCI/NAED MFG #01 8997	TRADE SIZE	UNIT PKG	STD PKG	DIM A	DIM B	DIM C
4400	04400	1/2	100	1000	1.140	.679	.505
4401	04401	3/4	100	1000	1.420	.900	.505
4402	04402	1	50	500	1.770	1.157	.505
4403	04403	1-1/4	25	250	2.281	1.509	.505
4404	04404	1-1/2	25	250	2.598	1.748	.505
4405	04405	2	20	200	2.919	2.223	.563
4406	04409	2-1/2	20	200	3.421	2.725	.563

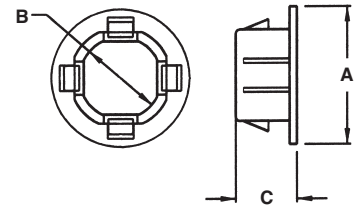

Snap-In Blanks

All plastic. For knockouts. Grey color.



CATALOG NUMBER	UPC/DCI/NAED MFG #01 8997	TRADE SIZE	UNIT PKG	STD PKG	DIM A	DIM B
NM900*	54000	1/2	100	1000	1.015	.468
NM901†	54001	3/4	50	50	1.250	.468
NM902†	54002	1	50	50	1.500	.468
NM903†	54003	1-1/4	25	25	1.906	.468
NM904†	54004	1-1/2	25	25	2.156	.468
NM905†	54005	2	20	20	2.750	.750

*UL and CSA listed.

†UL recognized.



These items cost less than steel snap-in blanks, and provide a safer installation. A metal blank in a plastic box or enclosure is not grounded and could become a shock hazard.

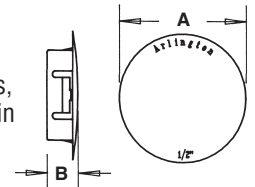

Snap-In Blanks

Plated steel. For knockouts.



CATALOG NUMBER	UPC/DCI/NAED MFG #01 8997	TRADE SIZE	UNIT PKG	STD PKG	DIM A	DIM B
900	00900	1/2	100	1000	1.070	.310
901	00901	3/4	50	50	1.235	.310
902	00902	1	50	50	1.480	.310
903	00903	1-1/4	25	25	1.800	.310
904	00904	1-1/2	25	25	2.215	.360
905	00905	2	20	20	2.675	.360

